

First Floor Plan

Scale - 1:100

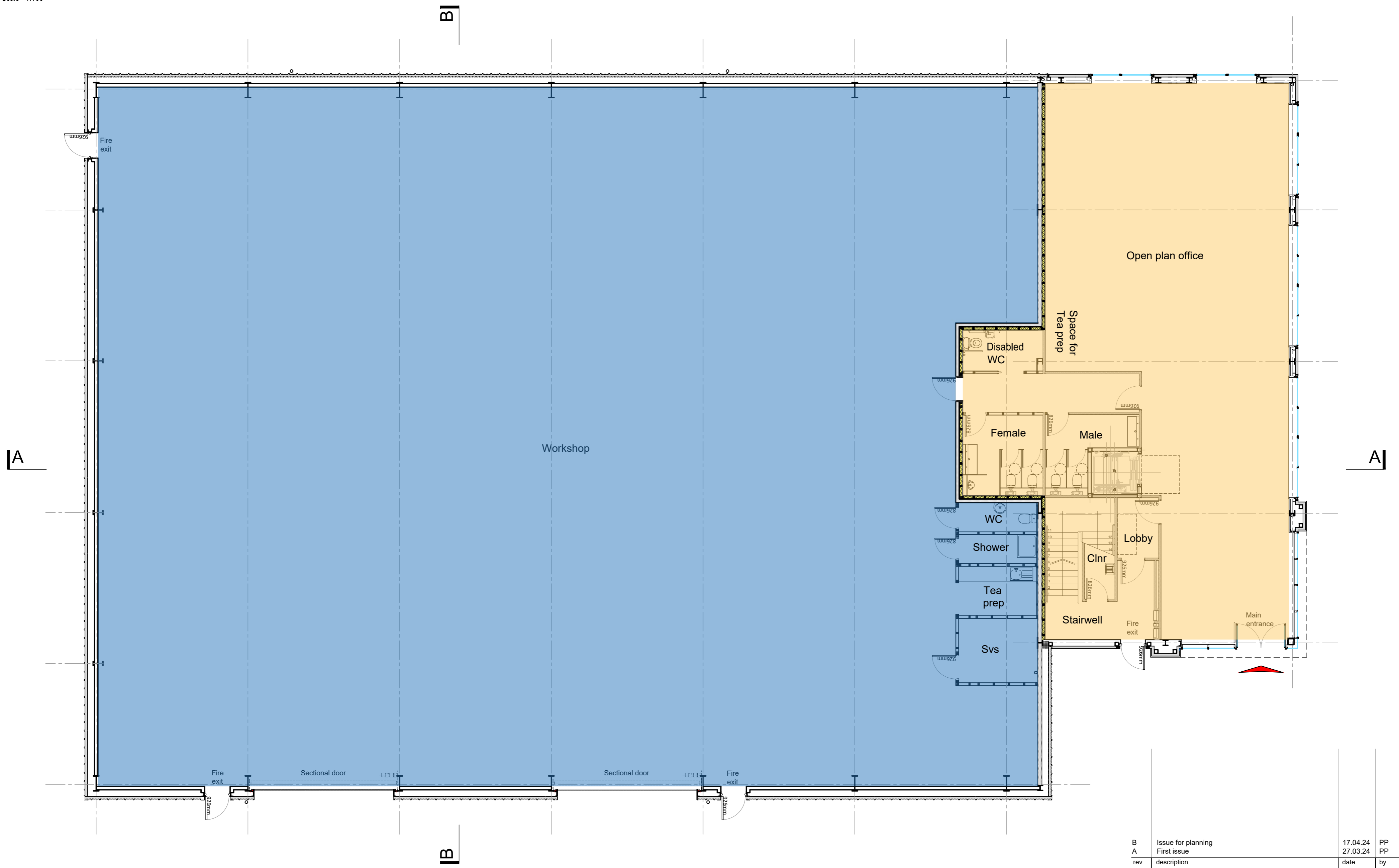

Ground Floor Plan

Scale - 1:100

Gross Internal Areas
 Office - 465.6m² (5,011 sqft)
 Workshop - 1,004.4m² (10,811 sqft)

- Office
- Workshop

Building Envelope U-Values

Floor: 0.15W/m²K
 Walls (RW cladding): 0.18W/m²K
 Walls (MR cladding): 0.19W/m²K
 Roof: 0.16W/m²K
 Roof Lights: 1.9W/m²K
 Vehicle Doors: 1.50W/m²K
 Windows: 1.5W/m²K
 External Doors: 1.4W/m²K

B	Issue for planning	17.04.24	PP	GW
A	First issue	27.03.24	PP	GW
rev	description	date	by	checked

DO NOT SCALE. Use figured dimensions only. All dimensions, spot levels and drainage positions to be checked on site by Contractor prior to construction. Any discrepancies to be reported back to Space Solutions. Drawings to be read & fully understood before work commences. **IF IN DOUBT ASK.**

Bishop House, 50 Carden Place,
 Aberdeen, AB10 1UP
 tel: +44(0)1224 218 500
 www.spacesolutions.co.uk

PLANNING

client	Knight Property Group	date	March 2024
address	Plots 9, Kingshill Comm Pk, Westhill	drawn by	PP
title	Ground Floor and First Floor Layout	checked	GW
scale	1:100@A1		

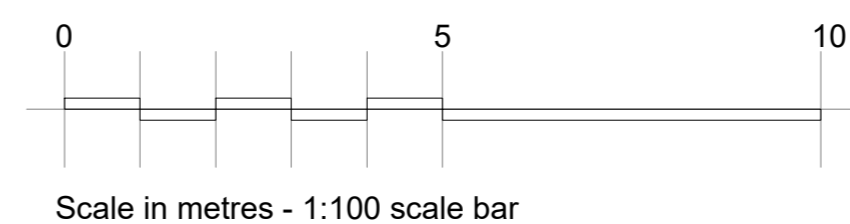

Scale in metres - 1:100 scale bar

job number	224912-A-PRO	drawing no.	A_210	rev	B
------------	---------------------	-------------	--------------	-----	----------

© Copyright of Space Solutions (Scotland) Ltd
 Aberdeen | Dundee | Edinburgh | Glasgow | London