

Your space, your way...

INDICATIVE FLOOR PLATE

GROUND FLOOR

920.69 SQ.M (9,910 SQ.FT)

RECEPTION

51.41 SQ.M (553 SQ.FT)

TOTAL BUILDING SIZE

1,894 SQ.M (20,393 SQ.FT)

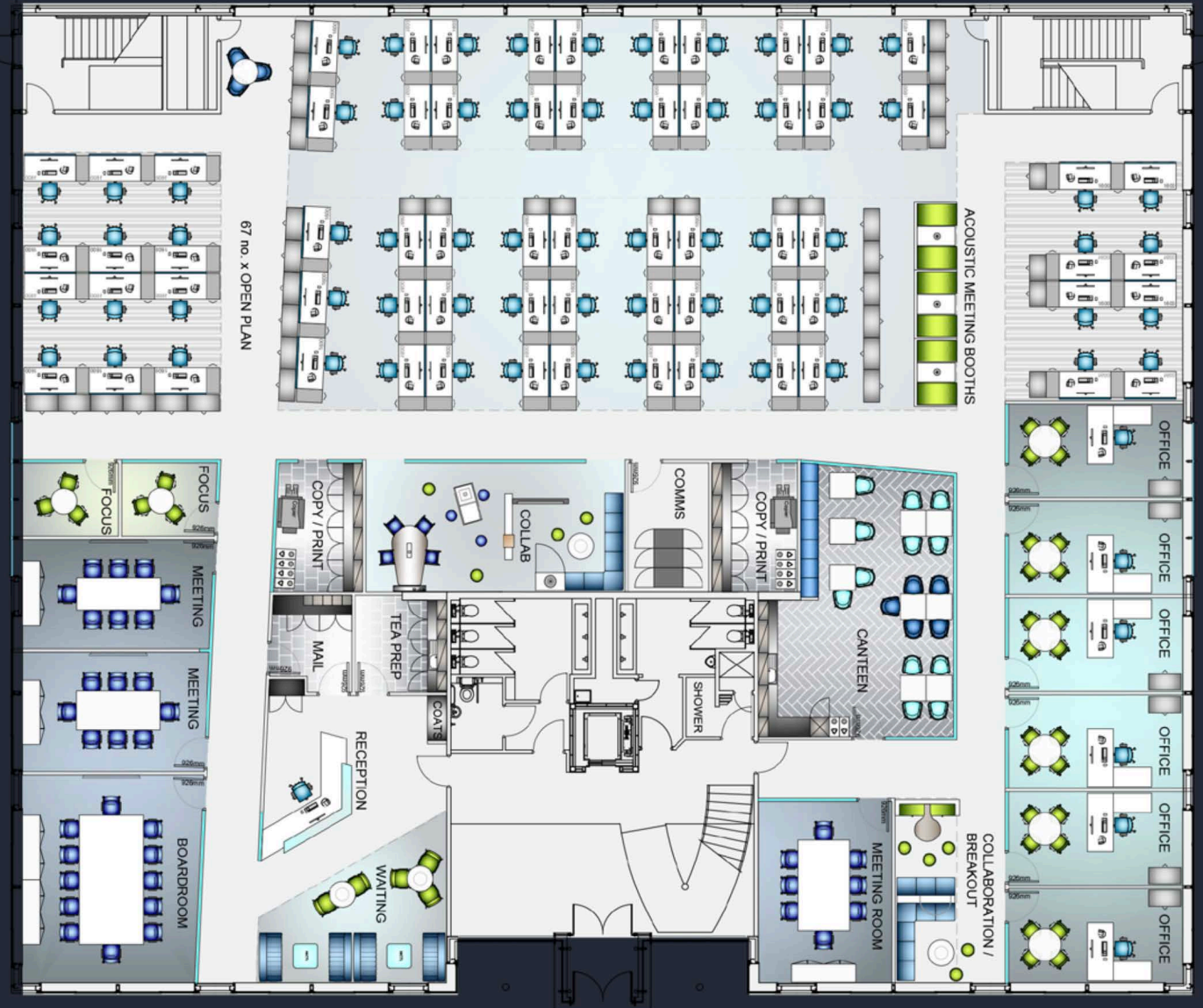



POTENTIAL EXPANSION

FULL FIRST FLOOR

922.50 SQ.M (9,930 SQ.FT)

HALF FIRST FLOOR

461.25 SQ.M (4,965 SQ.FT)

FLOOR PLATE OPTIONS FROM

4,037 SQ.FT - 9,930 SQ.FT