

# Flexible Availability

Location	Area	
Ground Floor Office Space Reception	10,737 ft <sup>2</sup> 565 ft <sup>2</sup>	These floors can be subdivided into smaller suites as illustrated here:
First Floor Office Space	10,773 ft <sup>2</sup>	
Second Floor Office Space Board Room	10,982 ft <sup>2</sup> 535 ft <sup>2</sup>	
<b>Total</b>	<b>33,592 ft<sup>2</sup></b>	

**KEY**

- 1 Female WC
- 2 Disabled WC
- 4 Lifts
- 6 Boardroom
- 3 Cleaner Closet
- 5 Male WC
- 7 Reception



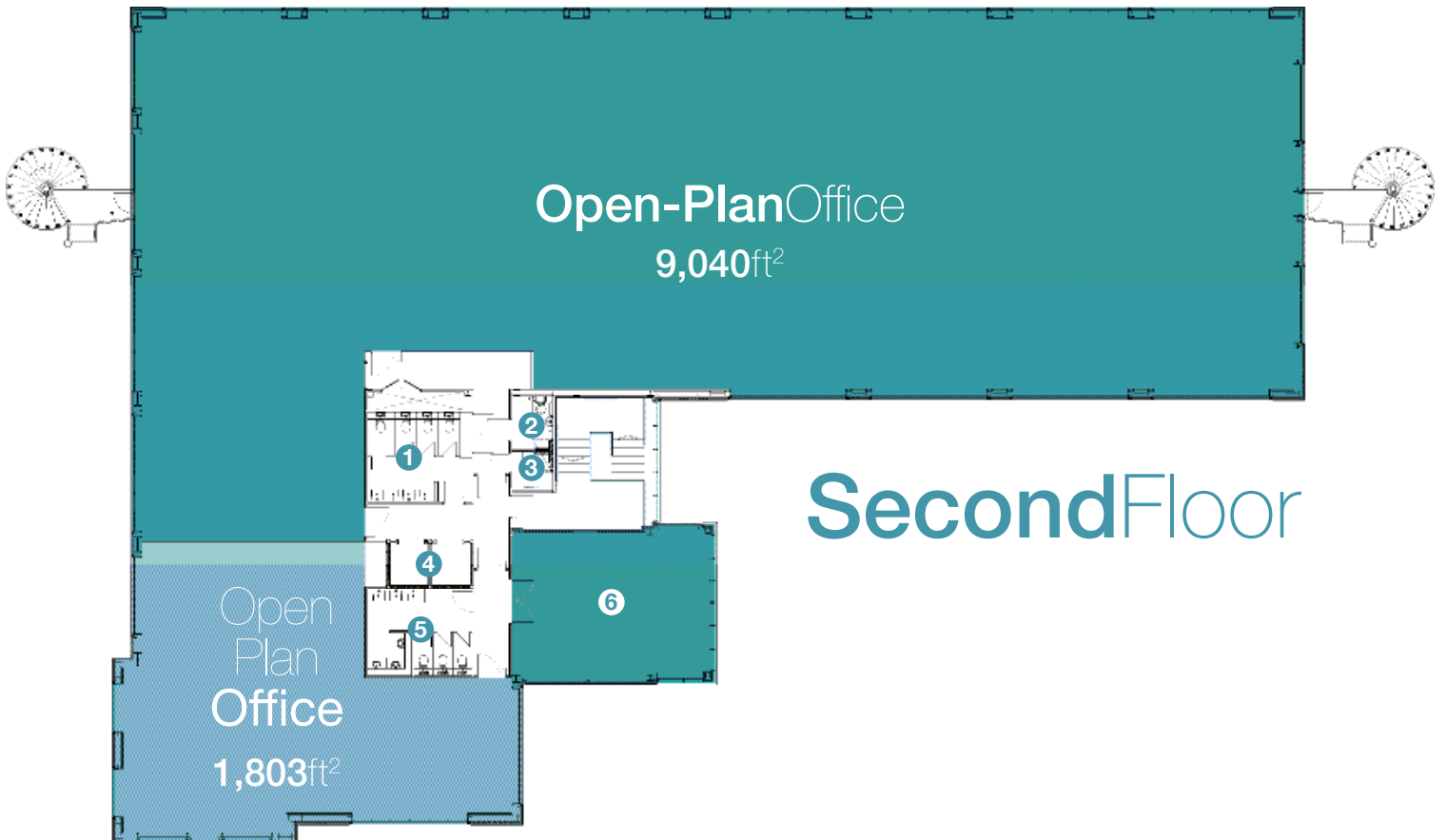
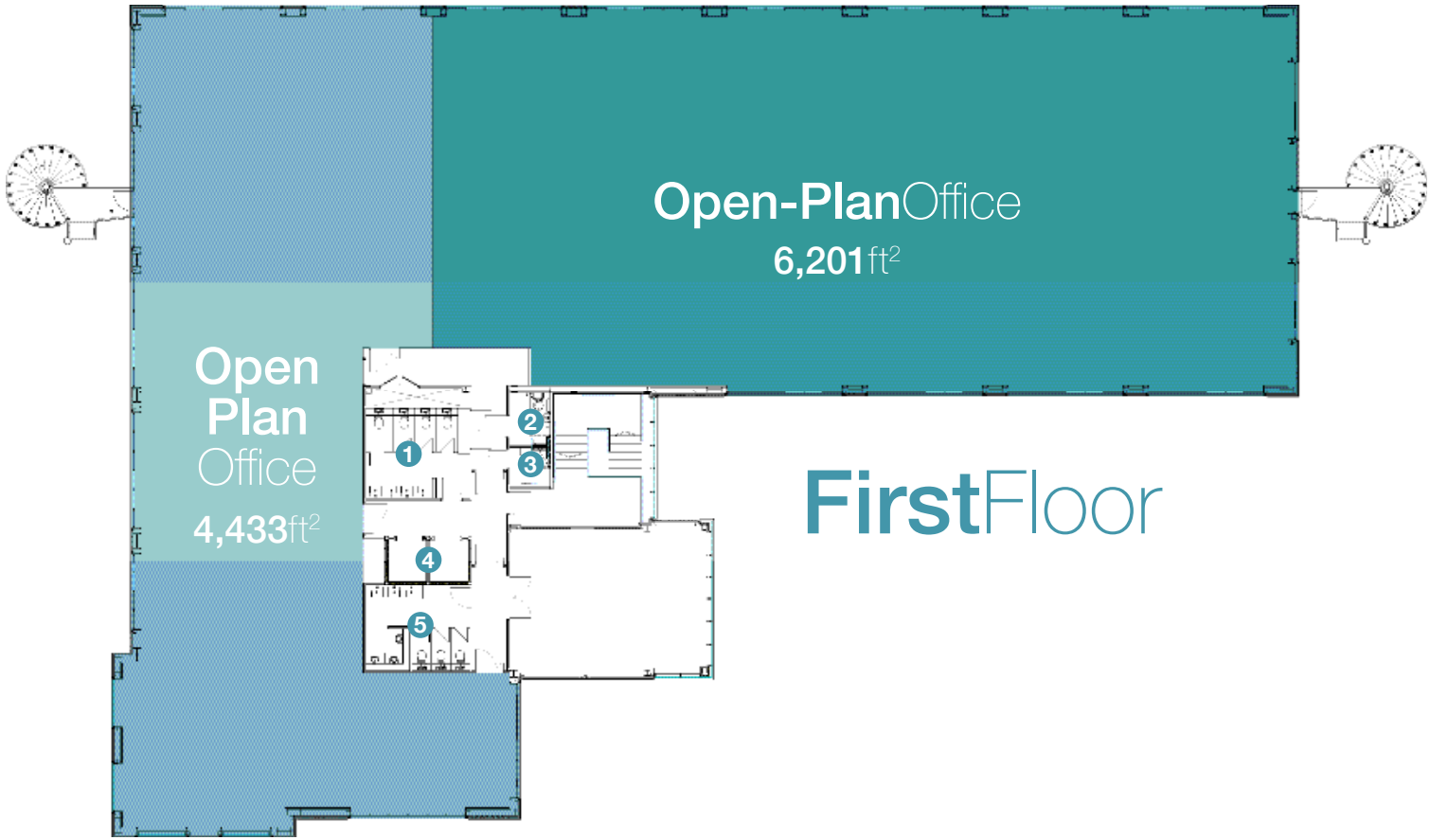

A partnership development



[www.knight-cityview.co.uk](http://www.knight-cityview.co.uk)

## LEASE TERMS

The accommodation is available to let on full repairing and insuring terms. Further information is available on request.

## SALE

A sale of the freehold would be considered.

## RENTAL

Information on quoting rental is available on application.

## LEGAL COSTS

The ingoing tenant will be responsible for their legal expenses, together with SDLT and Registration Dues.

## VAT

All figures quoted are exclusive of VAT.

## RATING ASSESSMENT

A guide to rating assessment is available on request.

To discuss how Knight Property Group can accommodate you at CityView Business Park, please contact our joint letting agents:

**Ryden**.co.uk  
01224 588866

Arron Finnie or Andrew Smith  
t: 01224 588866  
e: arron.finnie@ryden.co.uk  
e: andrew.smith@ryden.co.uk

 **FG Burnett**

Graeme Nisbet or Jonathan Nesbitt  
t: 01224 572661  
e: graeme.nisbet@fgburnett.co.uk  
e: jonathan.nesbitt@fgburnett.co.uk