

# Your space, your way...

## INDICATIVE FLOOR PLATE

### GROUND FLOOR

920.69 SQ.M (9,910 SQ.FT)

### RECEPTION

49.55 SQ.M (533 SQ.FT)

### TOTAL BUILDING SIZE

1,892.74 SQ.M (20,393 SQ.FT)

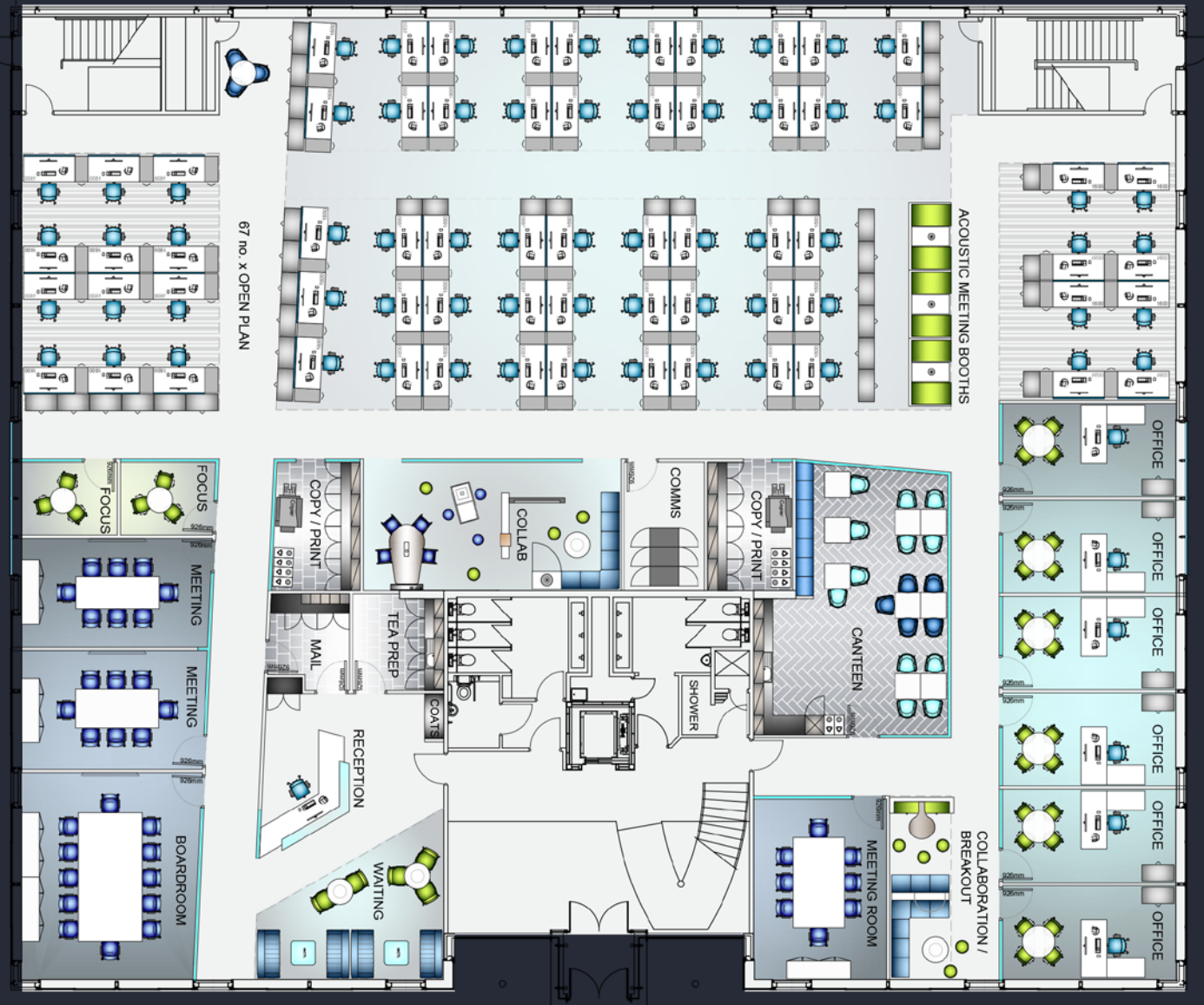



## POTENTIAL EXPANSION

### FULL FIRST FLOOR

922.50 SQ.M (9,930 SQ.FT)

### HALF FIRST FLOOR

461.25 SQ.M (4,965 SQ.FT)

### FLOOR PLATE OPTIONS FROM

4,037 SQ.FT - 9,930 SQ.FT